

## Bolt head

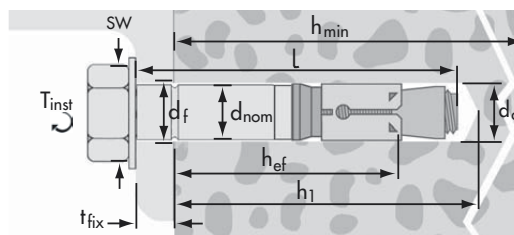

No.	Name	Material	No.	Name	Material
1	Hexagon screw	Zinc plated steel 8.8	4	Collapsible sleeve	Plastic PE
2	Washer	Zinc plated steel	5	Expansion sleeve	Zinc plated steel
3	Spacer sleeve	Zinc plated steel	6	Expansion cone	Zinc plated steel

## Building materials

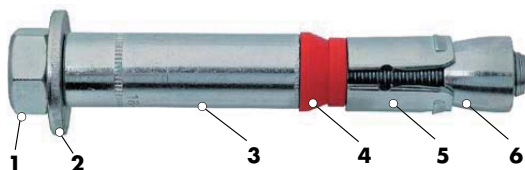

C20/25  
C50/60

## Characteristics

## Approvals



M8 - M16

F30 - F120

## Qualities

- Pre-assembled with hexagon screw.
- For most concrete qualities C20/25 - C50/60.
- For loads from 2.0 up to 31.3 kN.
- Collapsible plastic sleeve allows the anchor to tighten down, closing small gaps against the base material.

- Controlled expansion for the heavy load sector.
- Fastenings in solid natural stone without approval possible.
- Shock proof fastening in civil defence projects.

## Applications

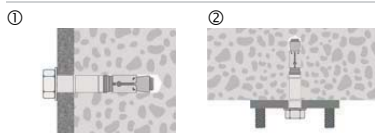

- ① Metal constructions on walls.
- ② Connection assemblies on ceilings.
- Approved for lightweight suspended ceilings according to DIN 18168 with 0.8 kN per plug.

- Large product range allows many different applications.
- For fixings in: metal constructions, machines, cables, pipings, scaffolds, railings, doors, stairs.

## Installation

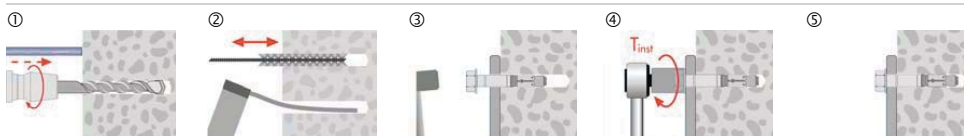

- ① Take drill hole-Ø and drill hole depth from the table.
- ② Clean the drill hole with a brush, then blow it out with a purging pump.
- ③ Position pre-drilled Building materials, drive the Heavy Duty Anchor into the material until the mark is reached.
- ④ Tighten the screw with a torque spanner to the pre-determined value  $T_{inst}$ .

All information detailed in our data sheets is based on technical approvals, formulas and site and laboratory testing under optimum conditions and include a stated safety factor. As we have no direct or indirect control over where or how our products are applied or installed, we do not accept any liability either directly or indirectly arising from the use of our products, whether or not in accordance with any advice, specification or recommendation given by us and we recommend site testing of all products for suitability.

Anchor size		M6	M8	M10	M12	M16	
N <sub>Zul</sub>	Approved tension load <sup>1)</sup> Concrete uncracked:						
	- C20/25	6.3	7.9	11.9	13.9	19.8	
	- C25/30	7.1	8.8	13.1	15.4	21.9	
	- C30/37	7.7	9.7	14.5	16.9	24.2	
	- C40/50	7.7	11.2	16.8	19.6	28	
	- C50/60	7.7	12.3	18.5	21.5	30.8	
	Concrete cracked:						
	- C20/25	2	4.8	6.3	9.9	13.9	
	- C25/30	2.2	5.3	7.1	11	15.4	
	- C30/37	2.4	5.8	7.7	12.1	16.9	
N <sub>Zul</sub>	- C40/50	2.8	6.7	9	14	19.6	
	- C50/60	3.1	7.4	9.8	15.4	21.5	
	Approved shear load Concrete cracked and uncracked:						
	- C20/25	6.9	11.4	17.1	20.4	28.6	
	≥ C25/30	6.9	11.4	17.1	22.4	31.3	
V <sub>Zul</sub>							
M <sub>Zul</sub>	Approved bending moment	Nm	7	17.1	34.2	60	152
c	Nom. distance to edge	mm	75	90	107	120	150
s	Nom. distance betw. anchors	mm	150	180	213	240	300
c <sub>min</sub> / s	Min. distance to edge	mm	50/100	60/120	70/175	80/200	100/220
s <sub>min</sub> / c	Min. distance betw. anchors	mm	50/80	60/100	70/120	80/160	100/180
h <sub>min</sub>	Min. thickness of foundation	mm	100	120	140	160	200
h <sub>ef</sub>	Effective anchorage depth	mm	50	60	71	80	100
SW	Spanner size	mm	10	13	17	19	24
T <sub>inst</sub>	Torque at anchoring	Nm	15	30	50	80	120
h <sub>1</sub>	Drill hole depth	mm	65	80	95	105	130
d <sub>0</sub>	Drill hole-Ø in the building material	mm	10	12	15	18	24
d <sub>cut</sub>	Max. drill cut-Ø	mm	10.45	12.5	15.5	18.5	24.55
d <sub>f</sub>	Hole-Ø in the attached part	mm	12	14	17	20	26
l	Anchor length	mm	60 70 90 110	70 80 100 120	85 100 110 130 180	100 110 120 140 170	120 140 170
d <sub>nom</sub>	Anchor-Ø	mm	10	12	15	18	24
t <sub>fix</sub>	Assembling length usable	mm	0 10 30 50	0 10 30 50	0 15 25 45 95	0 10 20 40 70	0 20 50



**Heavy Duty Anchor**

1) Without influence of anchor and edge distance

**Approved loads for fire resistance**

N <sub>Zul</sub>	F30	30 Minutes	1.8	2.6	7	10	16
	F60	60 Minutes	0.85	1.4	2.9	4.1	6.9
	F90	90 Minutes	0.55	0.95	1.75	2.5	4.25
	F120	120 Minutes	0.4	0.75	1.2	1.7	3

All information detailed in our data sheets is based on technical approvals, formulas and site and laboratory testing under optimum conditions and include a stated safety factor. As we have no direct or indirect control over where or how our products are applied or installed, we do not accept any liability either directly or indirectly arising from the use of our products, whether or not in accordance with any advice, specification or recommendation given by us and we recommend site testing of all products for suitability.

Reduction factors for distance between anchors

Anchor size		M6	M8	M10	M12	M16
Anchor-Ø	mm	10	12	15	18	24
50	mm	0.67				
55	mm	0.68				
60	mm	0.70	0.67			
65	mm	0.72	0.68			
70	mm	0.73	0.69			
75	mm	0.75	0.71	0.68		
80	mm	0.77	0.72	0.69	0.67	
85	mm	0.78	0.74	0.70	0.68	
90	mm	0.80	0.75	0.71	0.69	
95	mm	0.82	0.76	0.72	0.70	
100	mm	0.83	0.78	0.73	0.71	0.67
105	mm	0.85	0.79	0.75	0.72	0.68
110	mm	0.87	0.81	0.76	0.73	0.68
115	mm	0.88	0.82	0.77	0.74	0.69
120	mm	0.90	0.83	0.78	0.75	0.70
125	mm	0.92	0.85	0.79	0.76	0.71
130	mm	0.93	0.86	0.81	0.77	0.72
135	mm	0.95	0.88	0.82	0.78	0.73
140	mm	0.97	0.89	0.83	0.79	0.73
145	mm	0.98	0.90	0.84	0.80	0.74
150	mm	1	0.92	0.85	0.81	0.75
160	mm		0.94	0.88	0.83	0.77
170	mm		0.97	0.90	0.85	0.78
180	mm		1	0.92	0.88	0.80
190	mm			0.95	0.90	0.82
200	mm			0.97	0.92	0.83
213	mm			1	0.94	0.86
220	mm				0.96	0.87
230	mm				0.98	0.88
240	mm				1	0.90
250	mm					0.92
260	mm					0.93
270	mm					0.95
280	mm					0.97
290	mm					0.98
300	mm					1
Distance to the edge c >	mm	80	100	120	160	180

All information detailed in our data sheets is based on technical approvals, formulas and site and laboratory testing under optimum conditions and include a stated safety factor. As we have no direct or indirect control over where or how our products are applied or installed, we do not accept any liability either directly or indirectly arising from the use of our products, whether or not in accordance with any advice, specification or recommendation given by us and we recommend site testing of all products for suitability.

**Reduction factors for close to edge distances**

Anchor size		M6	M8	M10	M12	M16	
Anchor-Ø		10	12	15	18	24	
Distance to the edge c	50	mm	0.83				
	55	mm	0.87				
	60	mm	0.90	0.83			
	65	mm	0.93	0.86			
	71	mm	0.97	0.89	0.83		
	75	mm	1	0.92	0.85		
	80	mm		0.94	0.88	0.83	
	85	mm		0.97	0.90	0.85	
	90	mm		1	0.92	0.88	
	95	mm			0.95	0.90	
	100	mm			0.97	0.92	0.83
	107	mm			1	0.95	0.86
	110	mm				0.96	0.87
	115	mm				0.98	0.88
	120	mm				1	0.90
	125	mm					0.92
	130	mm					0.93
	135	mm					0.95
140	mm					0.97	
145	mm					0.98	
150	mm					1	
Distance between anchors s >		mm	100	120	175	200	220

**Increase factors**

If the concrete strength is higher than C20/25 the tension loads can be multiplied by following factors:

Concrete strength	Increase factor
C30/37	1.22
C40/50	1.41
C50/60	1.55